



## 9 Sloan Court, Stevenage, SG1 5HR

Guide price **£160,000**

Guide Price £160,000 - £170,000 Chain Free.

Located in Pin Green Stevenage, is this first floor, one bedroom flat with communal parking and gardens.

Step inside an entrance hallway leading through to the lounge. A large window offers views out to the front with a leafy canopy offering privacy, and there is built in shelving for storage. Off the lounge is the kitchen finished with white cabinets, grey worktops and black tiling, with space for an electric oven, fridge freezer and washing machine.

The bedroom is a good size again with views to the front. Completing the living space is a modern three-piece bathroom with a vanity sink and bath.

### **Lease Information**

Lease from: 3 November 2014 To and including 28  
January 2197 (171 years reaming)  
Service Charge: Approx £80 per month.  
The seller will pay the section 20 charge.

## Floor Plan

### First Floor

Approx. 45.4 sq. metres (489.0 sq. feet)

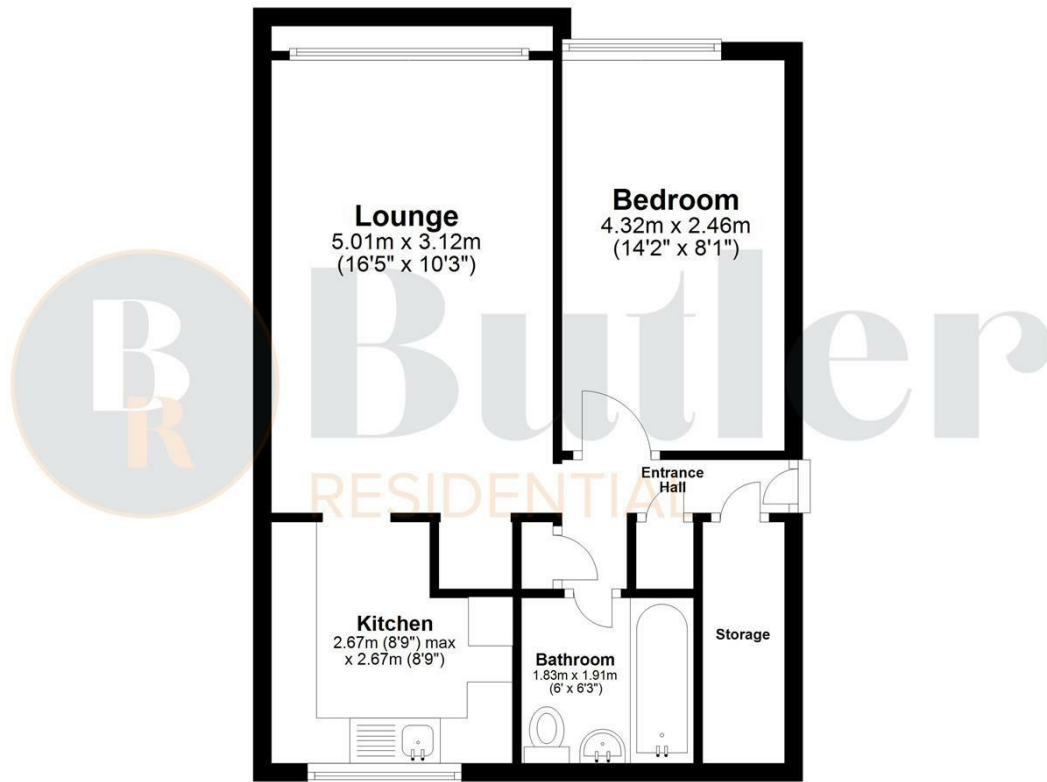

Total area: approx. 45.4 sq. metres (489.0 sq. feet)

## Area Map

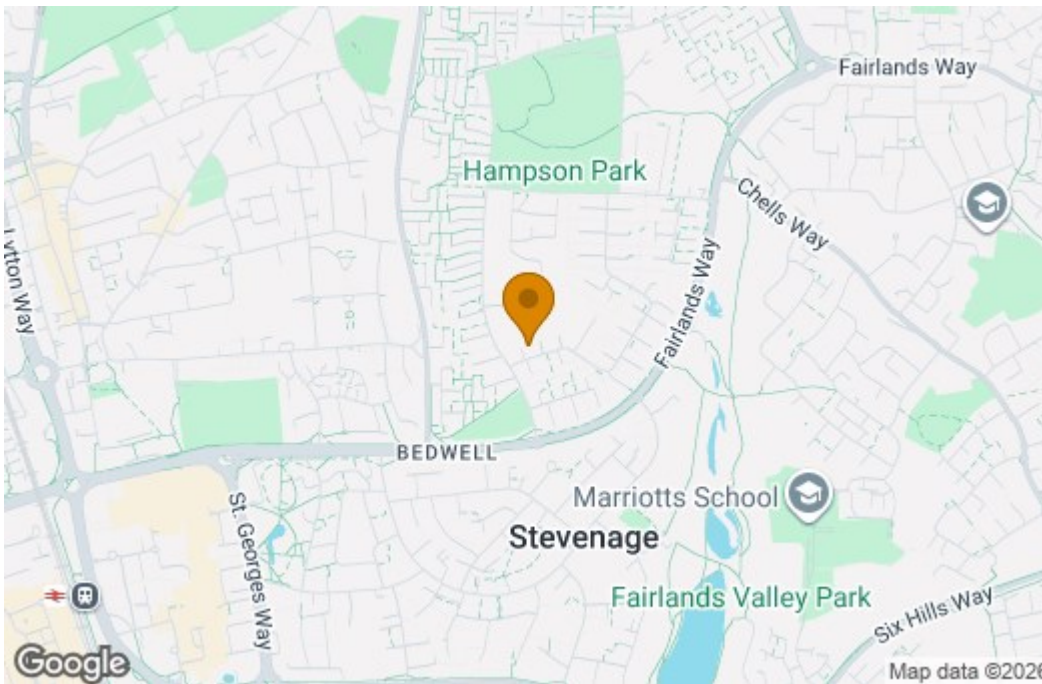

## Energy Efficiency Graph

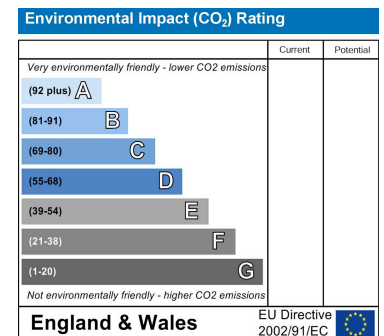
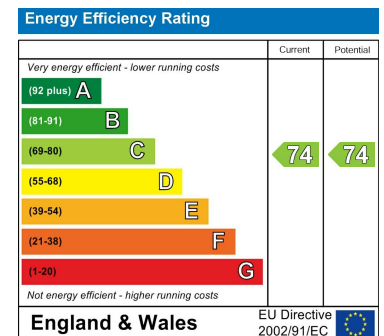

These particulars, whilst believed to be accurate are set out as a general outline only for guidance and do not constitute any part of an offer or contract. Intending purchasers should not rely on them as statements of representation of fact, but must satisfy themselves by inspection or otherwise as to their accuracy. No person in this firm's employment has the authority to make or give any representation or warranty in respect of the property.

**Address:** Suite 2, First Floor, Unit B, Balbir House Norton Green Road, Stevenage, SG1 2LP

**Tel:** 01438 584400

**Email:** hello@butlerresidential.co.uk

